

Indiana State University
School of Nursing
Learning Resource Center

1. **Hours:** The Learning Resource Center is open 8:00 AM to 4:30 PM Monday-Friday.
2. **LRC Lounge area** includes the College Lactation room (C-02), and Study/Small group work areas (C-01).
 - a. The **Nursing Testing Assistant's office** (C-03) and Testing area (C-03A) are adjacent to the LRC Lounge.
 - i. [Nursing Testing Program](#)
 - b. The **Director / Technology Coordinator's office** (Rm C-05) is adjacent to the LRC Lounge.
 - i. Resource / Practice materials are available for sign out. Students are responsible for items until returned.
 - ii. If class times, meetings, etc. make it difficult to contact the Director / Technology Coordinator, please call 812.237.4295 for an appointment.
 - iii. Students should become familiar with the [LRC procedures](#)
3. **The Nursing Skills Labs** are located along the spine of the Arena and across the hall from the LRC Lounge area (see photo layout below)

S
P
I
N
E

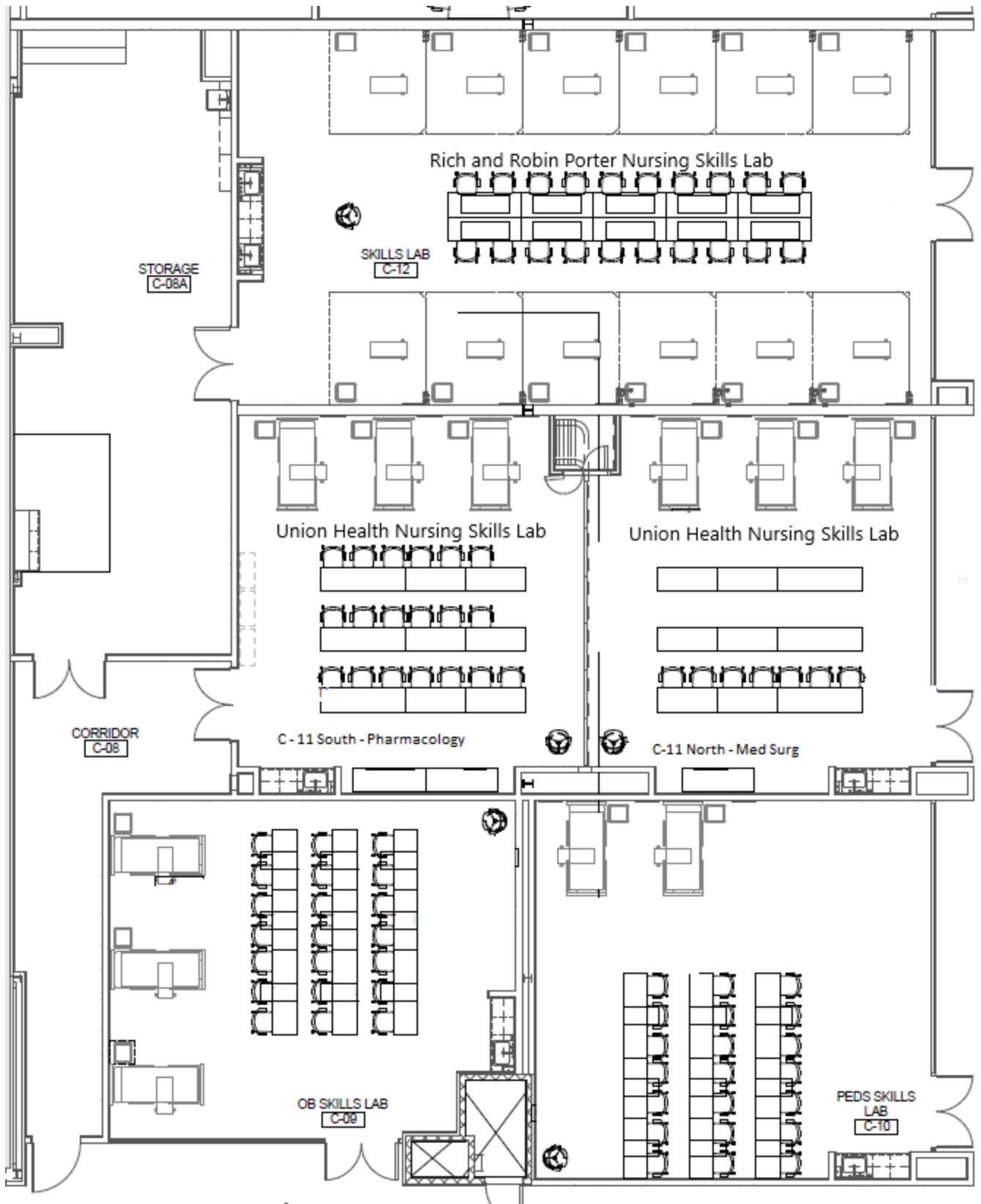

HALL

